



INVENTABLES™

X-CARVE

Quick Start & Resource Guide



Resources

X-Carve Manual and Guide

X-Carve FAQs:

https://inventables.desk.com/customer/en/portal/topics/820499-x-carve-faq/articles?b_id=9563

X-Carve Manual:

<http://x-carve-instructions.inventables.com/1000mm/>

X-Carve Basics and Community

Easel Basics: (★★ very helpful ★★)

<https://inventables.zendesk.com/hc/en-us/categories/360001068153-Easel>

Easel Live Classes:

<https://www.inventables.com/collections/29>

Inventables' Forum:

<https://discuss.inventables.com/>

CNC Subreddit:

<https://www.reddit.com/r/CNC/>

Software

Inkscape – Vector Graphics Software

<https://inkscape.org/en/>

Easel – Print Driver / Vector / CAM Software

<https://www.inventables.com/technologies/easel>

Materials

Laser Cutter Material Vendor:

<https://www.johnsonplastics.com>

<https://www.tapplastics.com>

<https://www.inventables.com/categories/materials/>

<https://www.interstateplastics.com>

X-Carve Quick Start Guide – Setup

This guide will help you get started but Inventables provides the most valuable information on their website. Follow the link under “Easel Basics” on the resource page to get the best understanding on how to successfully use the X-Carve.

Machine Specs

The X-Carve has a workspace of 39.37” x 39.37” or 1000mm². The Maximum size of material that can be cut is 800mm x 800mm x 65mm; however, our clamps will only allow material up to 2” thick. Most bits will not be able to reach the full 2”, so keep that in mind when choosing material.

1. **Turn on the X-Carve.** If you are looking at the machine from the front, you should be able to see the X-controller on the left hand side (black box with red emergency stop button on top). On the back of the X-Controller near the bottom in the center is the power switch.



2. Turn the computer on and go to <https://easel.inventables.com/> and login or create a free account with Inventables.

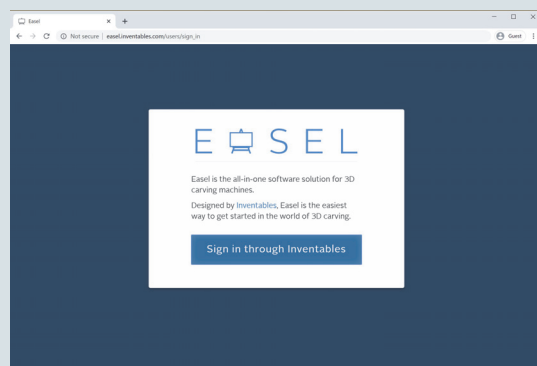

3. Once you are logged in you will see the Projects, Account, Toolbox and Options menu. You will need to open a project. Click on the “Intro to Easel” project or the “New project” button to begin.

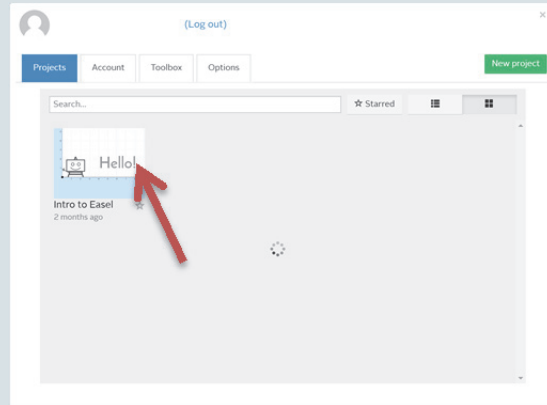

4. Before you run your first carve, you will have to go through the Machine Setup to make sure you have the correct firmware settings for your machine. Click the green “Carve” button and you will be prompted to setup your machine. You can also access this menu by clicking on “Machine” and “Setup your machine” from the Easel menu.

Enter your machine details

Select the settings that match your machine.

Machine type	X-Carve
Motion Controller	X-Controller
Rail size	1000mm x 1000mm
Lead screw	ACME threaded rod
Spindle	DeWalt 611
Dust shoe	<input checked="" type="checkbox"/>

You must use the correct settings for your machine to run correctly.

Confirm settings

(You can always change them later.)

- When the machine successfully connects, you'll be presented with a set of controls for jogging your machine. Try jogging the machine using the directional arrows. When standing in front of the X-Carve, X should jog the carriage left to right. Y should jog the gantry away from you and towards you. Z should jog the spindle up and down. If everything is wired correctly, you should get proper motion on each axis.

WARNING:

Use your mouse or keyboard to **TAP** the arrows to move your bit. **DO NOT PRESS AND HOLD** as this can cause damage to the machine, work piece, waste board and bit.

Test your wiring

Now we'll test that your motors are wired correctly. Test each axis using the controls and confirm that each axis moves correctly. We'll troubleshoot any axes that aren't working in the next step.

If you have homing switches, be careful jogging your machine. The switches are currently disabled and can easily be crushed.

	Working correctly?			
X			Yes	No
Y			Yes	No
Z			Yes	No



[Continue](#)

- You'll now be prompted to set your spindle settings.

You'll want to select **"Manual"** for your spindle control preference.

Spindle settings

Be sure your machine spindle dial is set to 1.



Should Easel control your spindle automatically or would you prefer to turn it on and off manually?

Spindle control preference
Manual

[Save spindle preference](#)

7. After you confirm your spindle setting, you'll be prompted to enable or disable homing.

Select **"No, disable homing"**

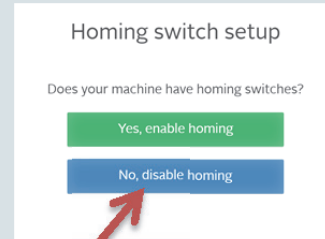

8. The last step is enabling up the z-probe.

Select **"No"**

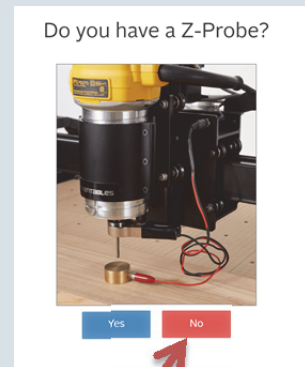

9. After setting your machine select "Finish" to return to the main menu.

